

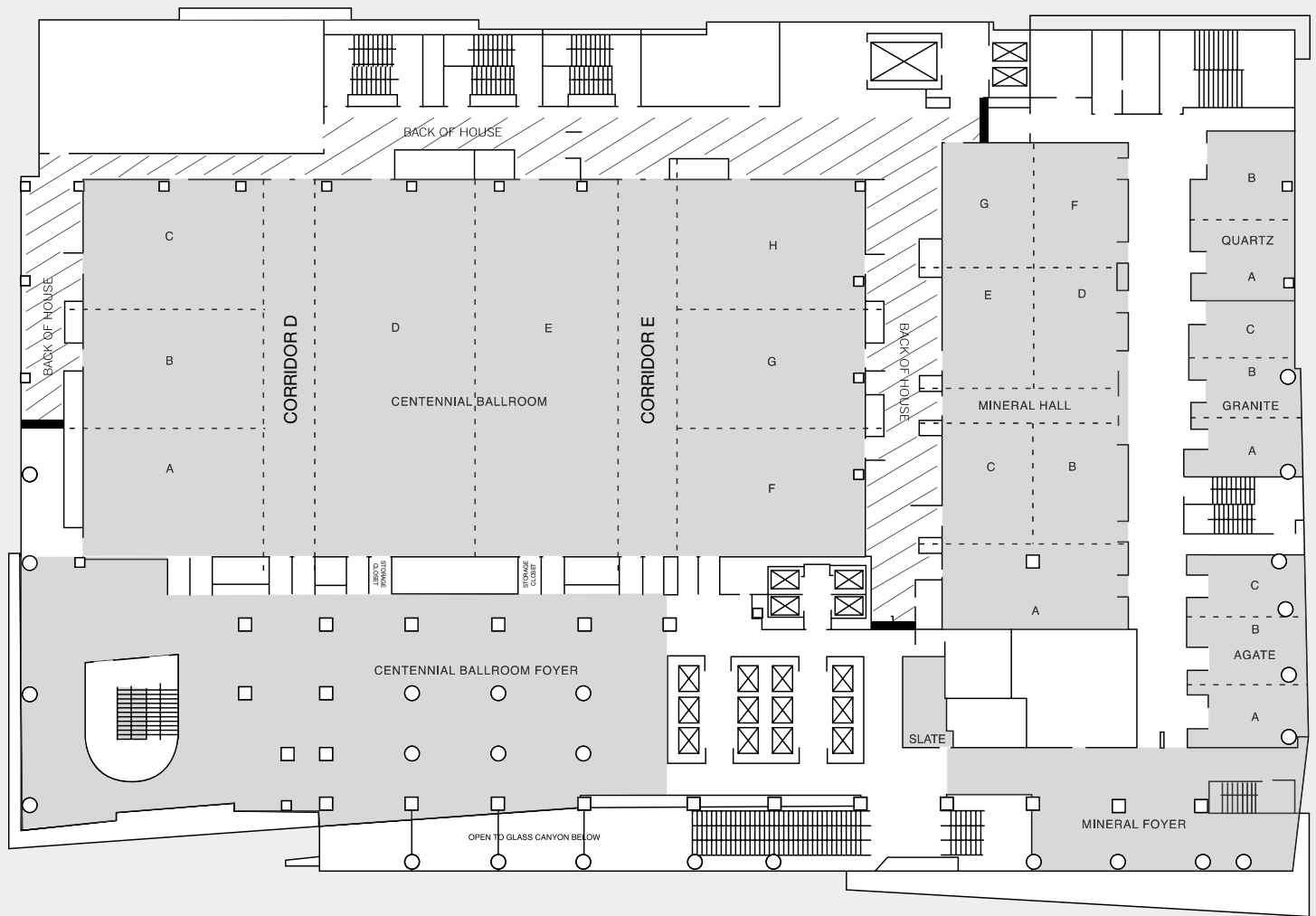

SMALL & LARGE MEETINGS
Capacities & Floor plans



FLOOR PLAN
Level Three





FLOOR PLAN
Level Four

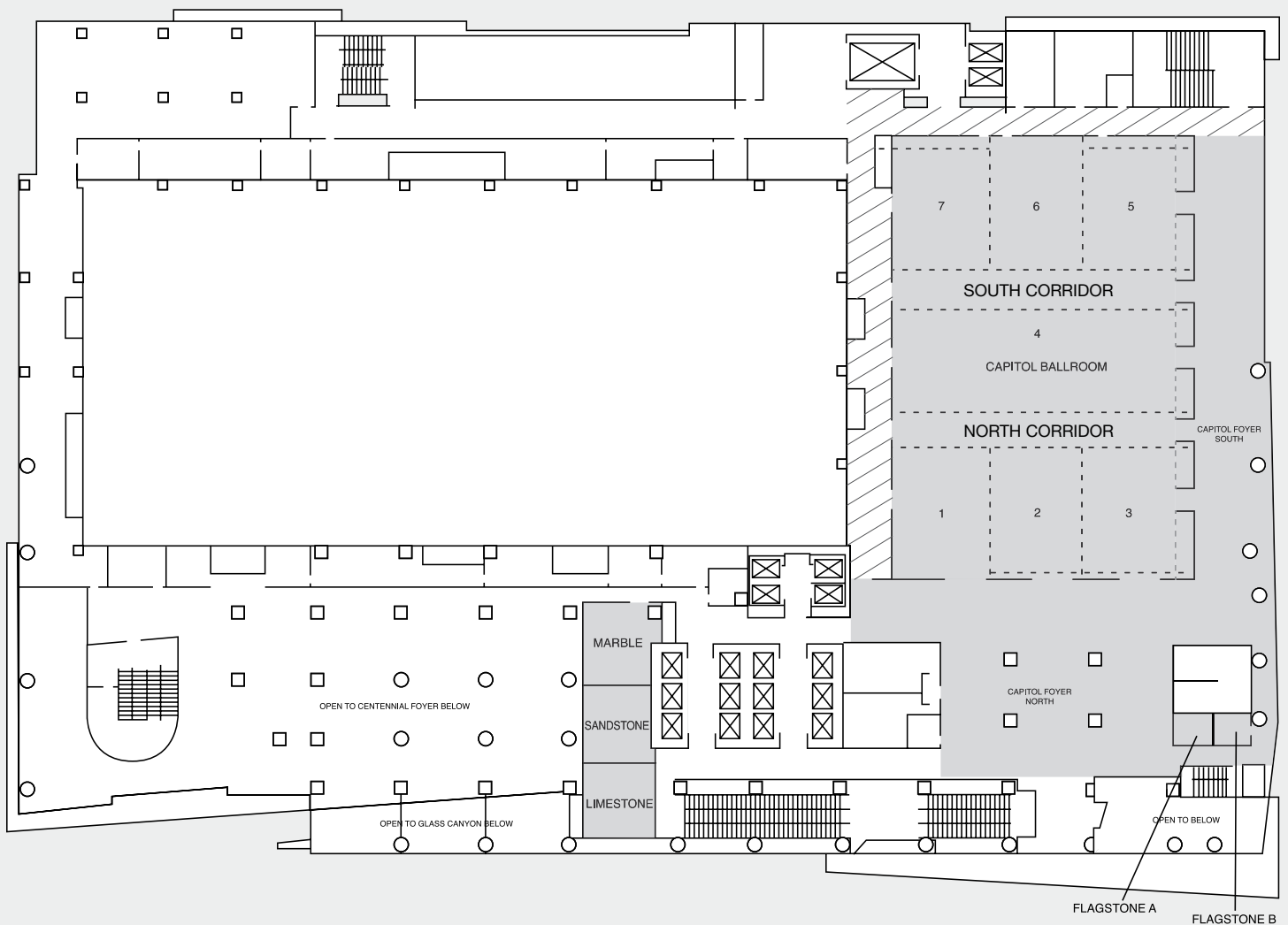

Event space located in other areas of the hotel:
 DENVER CITY TERRACE, 5th floor
 SUMMIT 25, 25th floor
 SUMMIT 26, 26th floor
 PEAKS LOUNGE, 27th floor, day-use only

HYATT REGENCY DENVER

AT COLORADO CONVENTION CENTER

650 Fifteenth Street
Denver, Colorado 80202
USA

T: +1 303 436 1234
F: +1 303 436 9102
E: dencc.rfp@hyatt.com
denverregency.hyatt.com



CAPACITY CHART



Room Name	Room Dimensions L x W x H	Room Size Sq. Ft.	Banquet Rounds of 10	Reception	Theater	Classroom	Boardroom	U-Shape	Hollow Square	Exhibit 8' x 10'
Third Floor										
CENTENNIAL BALLROOM	117' x 230' x 30'	30,000	1,890	3,000	2,200	1,900	-	-	-	177
A	39' x 55' x 30'	2,145	90	220	160	108	40	42	54	13
B	36' x 55' x 30'	1,980	90	200	140	108	40	42	54	10
C	39' x 55' x 30'	2,145	90	220	160	108	40	42	54	13
CORRIDOR D	117' x 17' x 30'	1,989	-	-	-	-	-	-	-	-
D	117' x 49' x 30'	5,733	360	600	430	370	-	-	-	36
E	117' x 49' x 30'	5,148	270	500	380	310	-	-	-	26
CORRIDOR E	117' x 19' x 30'	2,223	-	-	-	-	-	-	-	-
F	39' x 59' x 30'	2,301	90	220	160	108	40	42	54	14
G	36' x 59' x 30'	2,124	90	200	140	108	40	42	54	12
H	39' x 59' x 30'	2,301	90	220	160	108	40	42	54	14
CENTENNIAL FOYER	-	10,600	400	1,200	-	-	-	-	-	26
MINERAL HALL	151' x 54' x 10'	8,154	470	540	620	480	-	-	-	40
A	26' x 54' x 10'	1,404	70	100	72	54	40	39	42	-
B	37' x 26' x 10'	962	50	100	70	45	28	30	36	-
C	37' x 28' x 10'	1,036	50	100	80	45	28	30	36	-
CORRIDOR	10' x 54' x 10'	540	-	-	-	-	-	-	-	-
D	37' x 26' x 10'	962	50	100	70	45	28	30	36	-
E	37' x 28' x 10'	1,036	50	100	70	45	28	30	36	-
F	37' x 26' x 10'	962	50	100	80	45	28	30	36	-
G	37' x 28' x 10'	1,036	50	100	80	45	28	30	36	-
MINERAL HALL FOYER	-	2,400	70	120	-	-	-	-	-	5
AGATE	60' x 32' x 10'	1,800	60	140	110	60	46	42	48	8
A	18' x 31' x 10'	558	20	40	30	18	16	15	18	-
B	19' x 30' x 10'	570	20	40	30	18	16	15	18	-
C	23' x 29' x 10'	667	20	40	40	24	20	15	18	-
GRANITE	61' x 27' x 10'	1,647	70	140	110	60	52	48	54	8
A	21' x 27' x 10'	567	20	40	40	24	20	18	24	-
B	20' x 27' x 10'	540	20	40	30	21	18	12	18	-
C	19' x 26' x 10'	494	20	40	30	21	16	12	24	-
QUARTZ	44' x 25' x 10'	1,100	50	100	80	54	34	36	42	6
A	23' x 25' x 10'	575	20	40	40	24	18	18	18	-
B	21' x 25' x 10'	525	20	40	40	24	18	18	18	-
SLATE	-	288	-	-	-	-	-	-	-	storage or office space
Fourth Floor										
CAPITOL BALLROOM	141' x 94' x 22'	14,000	840	1,200	960	750	-	-	-	80
1	41' x 32' x 22'	1,312	60	140	90	60	34	33	42	-
2	41' x 29' x 22'	1,189	60	130	90	54	34	33	42	-
3	41' x 31' x 22'	1,271	60	140	90	60	34	33	42	-
CORRIDOR NORTH	11' x 94' x 22'	1,034	-	-	-	-	-	-	-	-
4	33' x 94' x 22'	3,102	140	300	210	180	-	-	90	14
CORRIDOR SOUTH	12' x 94' x 22'	1,128	-	-	-	-	-	-	-	-
5	42' x 31' x 22'	1,302	60	140	90	72	34	33	42	-
6	42' x 29' x 22'	1,218	60	130	90	54	34	33	42	-
7	42' x 32' x 22'	1,344	60	140	90	72	34	33	42	-
CAPITOL FOYER	-	8,000	300	900	-	-	-	-	-	18
LIMESTONE	-	560	-	-	-	-	-	-	-	permanent boardroom seating for 14
SANDSTONE	-	525	-	-	-	-	-	-	-	permanent boardroom seating for 14
MARBLE	-	540	-	-	-	-	-	-	-	permanent boardroom seating for 14
FLAGSTONE A	-	99	-	-	-	-	-	-	-	storage or office space
FLAGSTONE B	-	99	-	-	-	-	-	-	-	storage or office space
SUMMIT 25 AND 26	25' x 24' x 7'	380	12	-	24	15	12	9	12	-
DENVER CITY TERRACE	110' x 32'	3500	160	300	300	-	-	-	-	-